



# Promaster 250Z & 260Z

## Owner/Operator Manual

### Models

- 992018 - PM 260Z
- 992020 - PM 260Z
- 992021 - PM 260Z
- 992022 - PM 260Z
- 992023 - PM 250Z
- 992024 - PM 260Z
- 992027 - PM 260Z

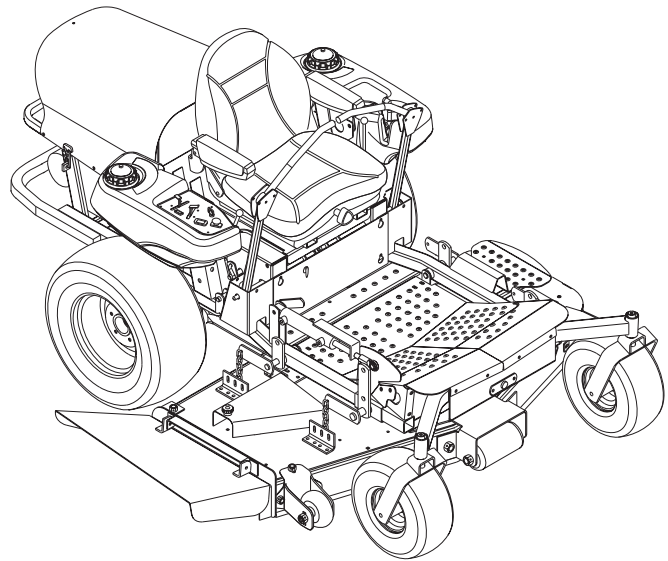

- GB ENGLISH
- F FRANÇAIS
- E ESPAÑOL

# CONTROLS AND FEATURES

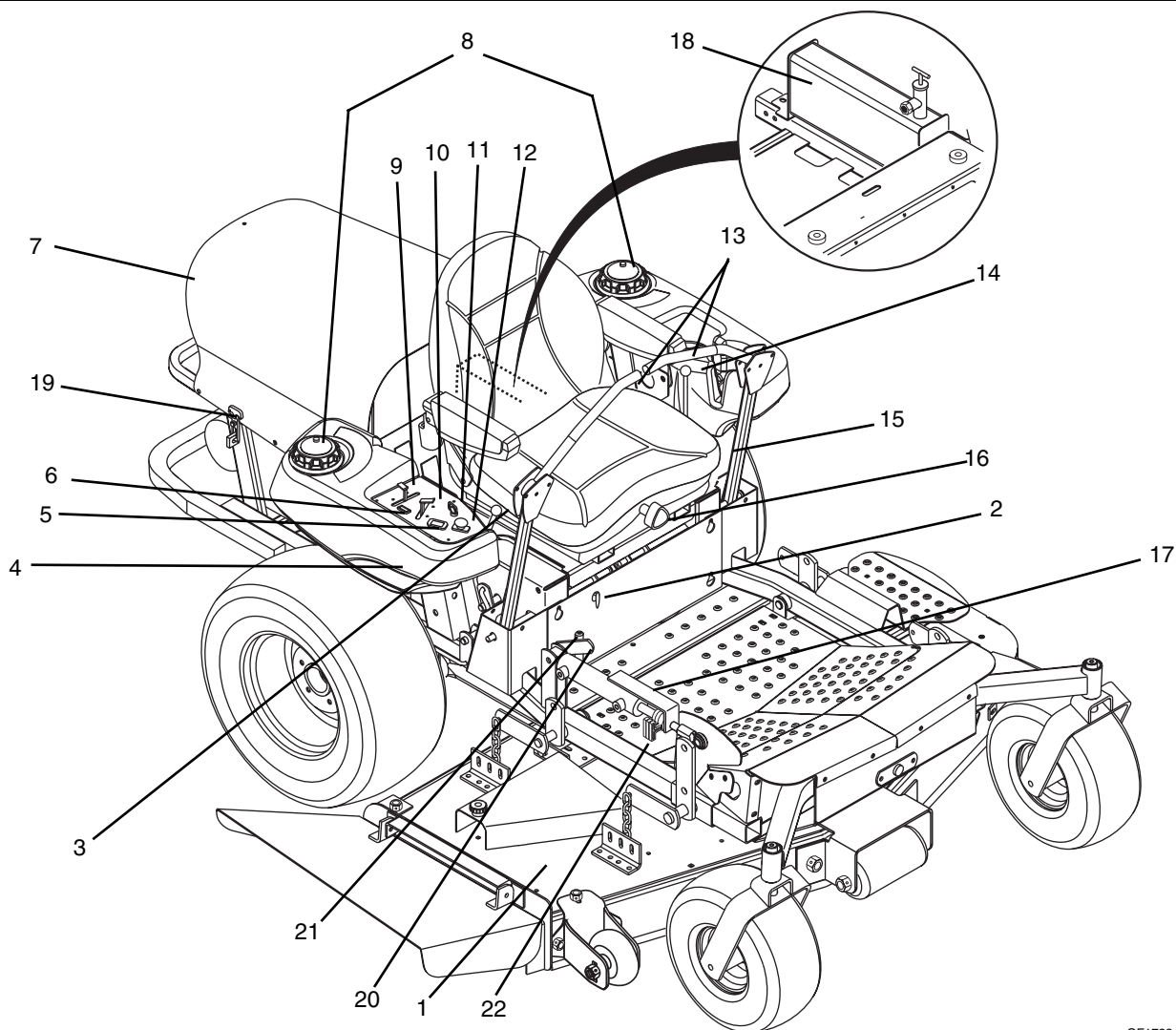

Figure 1

OF1722

## ENGLISH

1. Mower Deck with Chute Deflector
2. Fuel Shut Off Valve
3. Parking Brake
4. Battery
5. Hour Meter
6. Oil Pressure Indicator
7. Engine Frame and Hood (260Z)
8. Fuel Tanks and Caps
9. Choke Control
10. Throttle Lever
11. Ignition Switch
12. Power Take Off (PTO) Switch
13. Steering Levers
14. Mower Lift Lever
15. Seat Adjustment Lever
16. Seat Suspension Adjustment Knob (260Z)
17. Height of Cut Indicator
18. Hydraulic Oil Reservoir
19. Engine Hood Latch (260Z)
20. Foot Board Latch
21. Cylinder Stop Storage Post
22. Cylinder Stops

## **⚠ WARNING ⚠**

The engine exhaust from this product contains chemicals known to the State of California to cause cancer, birth defects or other reproductive harm.

## FRANÇAIS

1. Carter de coupe avec déflecteur
2. Robinet de carburant
3. Frein de stationnement
4. Batterie
5. Compteur horaire
6. Indicateur de pression d'huile
7. Châssis du moteur et capot (260Z)
8. Réservoirs de carburant et bouchons
9. Starter
10. Manette des gaz
11. Contacteur de démarrage
12. Contacteur de régime de la PdF
13. Leviers de direction
14. Levier de relevage de la tondeuse
15. Levier de réglage du siège
16. Levier de réglage de la suspension (260Z)
17. Indicateur de hauteur de coupe
18. Réservoir d'huile hydraulique
19. Verrou du capot du moteur (260Z)
20. Attache du repose-pied
21. Montant de remisage de butées de vérin
22. Butées de vérin

## ESPAÑOL

1. Plataforma de corte
2. Válvula de cierre de combustible
3. Freno de estacionamiento
4. Batería
5. Horómetro
6. Indicador de la presión del aceite
7. Motor y cubierta del motor (260Z)
8. Tapas y depósitos de combustible
9. Control de aire
10. Palanca de ralentí
11. Interruptor de encendido
12. Interruptor de la toma de fuerza (TDF)
13. Palancas de dirección
14. Palanca de elevación del cortacésped
15. Palanca de ajuste del asiento
16. Palanca de ajuste de la suspensión (260Z)
17. Altura del indicador de corte
18. Depósito de aceite hidráulico
19. Traba del capó del motor (260Z)
20. Traba de la plataforma de pie
21. Poste de almacenamiento del tope del cilindro
22. Topes de cilindro
23. Zylinderanschlag-Aufbewahrungspfofen
24. Zylinderanschläge

# TABLE OF CONTENTS

Controls and Features .....	3	Maintenance .....	15
Introduction.....	5	Attachments and Accessories .....	25
Safety.....	6	Maintenance Schedule .....	23
Assembly.....	11	Specifications.....	24
Operation.....	12	Warranty .....	Inside Back Cover

## INTRODUCTION

### THE MANUAL

Before operation of unit, carefully and completely read your manuals. The contents will provide you with an understanding of safety instructions and controls during normal operation and maintenance.

All reference to left, right, front, or rear are given from operator sitting in the operation position and facing the direction of forward travel.

### SERVICE AND REPLACEMENT PARTS

When ordering publications, replacement parts, or making service inquiries, know the Model and Serial numbers of your unit and engine. Numbers are located on the product registration form in the unit literature package. They are printed on a serial number label, located on the frame of your unit (Figure 2).

- Record Unit Model and Serial numbers here.

- Record Engine Model and Serial numbers here.

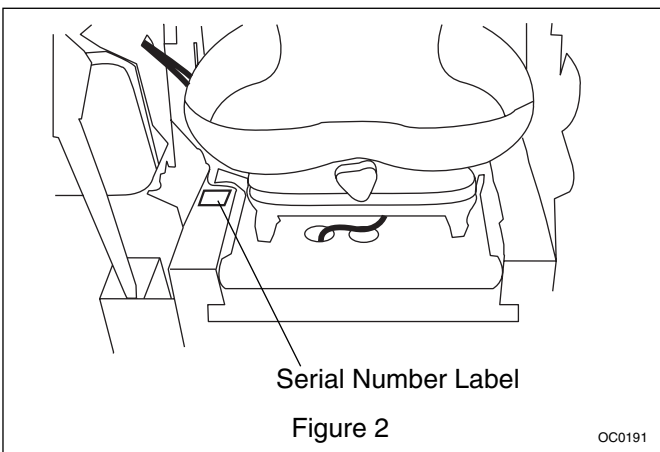

### PRODUCT REGISTRATION

A warranty card must be filled out, signed, and returned at time of purchase. This card activates the warranty. Claims meeting requirements during limited warranty period will be honored. Return your registration card to assure warranty service.

### UNAUTHORIZED REPLACEMENT PARTS

Use only Gravelly replacement parts. The replacement of any part on this equipment with anything other than a Gravelly authorized replacement part may adversely affect the performance, durability, and safety of this unit and may void the warranty. Gravelly disclaims liability for any claims or damages, whether regarding warranty, property damage, personal injury or death arising out of the use of unauthorized replacement parts.

### DISCLAIMER

Gravelly reserves the right to discontinue, change, and improve its products at any time without public notice or obligation to the purchaser. The descriptions and specifications contained in this manual were in effect at printing. Equipment described within this manual may be optional. Some illustrations may not be applicable to your unit.

### DEALER DELIVERY

Dealer should:

1. Test brakes (See Operation Section) after tractor is assembled to be sure adjustment has not been disturbed in shipment (See Adjustment Section). Wheel brakes are properly adjusted at factory.
2. Check the safety interlock system to make sure that it is functioning properly. With operator on seat, unit must not start unless Speed Selector is in neutral (N) and Implement Power disengaged (Off). Engine must stop if operator leaves seat when Speed Selector is in any drive position or with Implement Power engaged (On). Refer to Adjustment Section.
3. Fill out Original Purchaser Registration Card and return the card to Gravelly.
4. Explain Gravelly Limited Warranty Policy.

5. Explain recommended lubrication and maintenance. Advise customer on adjustments. Instruct customer on controls and operation of unit. Discuss and emphasize the Safety Precautions. Give customer Owner/Operator, Parts, and Engine Manuals. Advise customer to thoroughly read and understand them.

**Customer Note:** Your Dealer has been provided complete setup and preparation instructions which must be completed prior to you taking delivery of this unit. The dealer is required to review important information in this manual with you before or upon delivery of the unit or attachment.

## SAFETY



### SAFETY ALERT SYMBOL

These are safety alert symbols. They mean:

- **ATTENTION!**
- **YOUR SAFETY IS INVOLVED!**



When you see this symbol:

- **BECOME ALERT!**
- **OBEY THE MESSAGE!**

### REQUIRED OPERATOR TRAINING

Original purchaser of this unit was instructed by the seller on safe and proper operation. If unit is to be used by someone other than original purchaser (loaned, rented or sold), ALWAYS provide this manual and any needed safety training before operation.

### SAFETY DECALS AND LOCATIONS

ALWAYS replace missing or damaged Safety Decals. Refer to Figure 3 for Safety Decal locations.

### SIGNAL WORDS

The safety alert symbols above and signal words below are used on decals and in this manual.

Read and understand all safety messages.



**DANGER:** IMMINENTLY HAZARDOUS SITUATION! If not avoided, WILL RESULT in death or serious injury.



**WARNING:** POTENTIALLY HAZARDOUS SITUATION! If not avoided, COULD RESULT in death or serious injury.



**CAUTION:** POTENTIALLY HAZARDOUS SITUATION! If not avoided, MAY RESULT in minor or moderate injury. It may also be used to alert against unsafe practices.

### NOTATIONS

**NOTE:** General reference information for proper operation and maintenance practices.

**IMPORTANT:** Specific procedures or information required to prevent damage to unit or attachment.

### PRACTICES AND LAWS

Practice usual and customary safe working precautions, for the benefit of yourself and others. Understand and follow all safety messages. Be alert to unsafe conditions and the possibility of minor, moderate, or serious injury or death. Learn applicable rules and laws in your area.

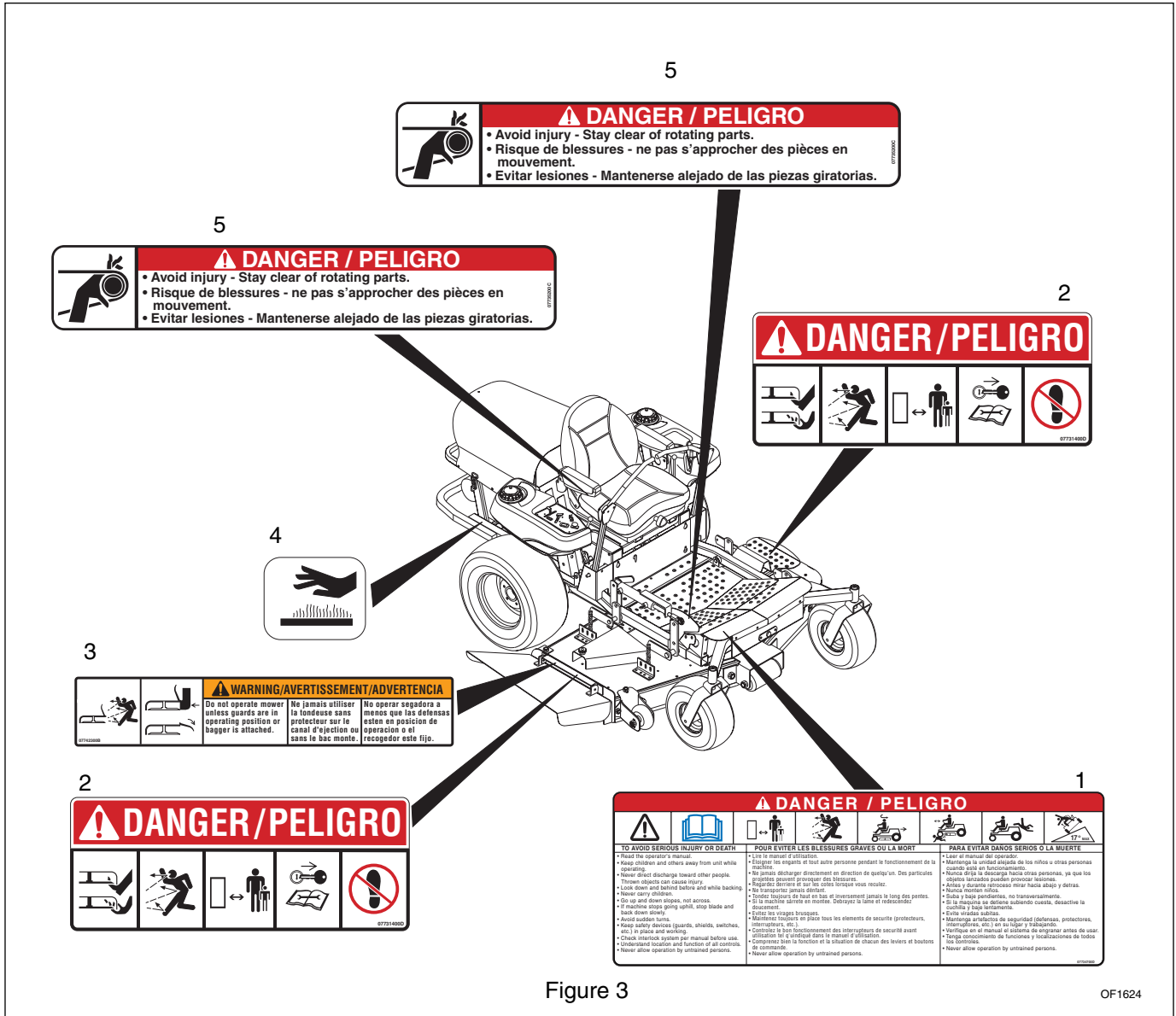

Figure 3

OF1624

**1. DANGER! TO AVOID SERIOUS INJURY OR DEATH**



OL1801

Read Owner/Operator Manual.



OL4370

Keep children and others away from unit while operating.



OL0910

Never direct discharge toward other people. Thrown objects can cause injury. Remove objects that could be thrown by the blade.



OL4460

Look down and behind before and while backing.



OL4470

Keep children out of work area and under watchful care of a responsible adult.



OL4480

NEVER CARRY CHILDREN.



OL4450

Go up and down slopes, not across. DO NOT operate on slopes over 17°.

- If machine stops going uphill, stop blade and back down slowly.
- Avoid sudden turns.
- Keep safety devices (guards, shields, switches, etc.) in place and working.

- Check interlock system per manual before use.
- Understand location and function of all controls.
- Never allow operation by untrained persons.

## 2. DANGER! ROTATING PARTS



OL3030

Always keep feet and hands away from rotating parts.



OL0910

Always stand clear of discharge area. Do not direct discharge toward other people.

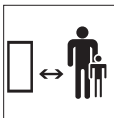

OL3292

Keep people away from unit while operating.



OL4010

Shut off engine, remove key, read manual before you adjust or repair unit.



OL4420

NO STEP! Always keep feet away from rotating parts.

## 3. WARNING! Do not operate mower unless guards are in operating position or bagger is attached.



OL4430

Always stand clear of discharge area.

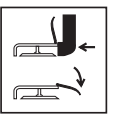

OL3320

Do not operate mower unless bagger is attached or guards are in operating position.

## 4. HOT SURFACES!



OS0731

DO NOT touch parts which are hot from operation. ALWAYS allow parts to cool.

## 5. DANGER!



OL4730

AVOID INJURY. Stay clear of rotating parts.

## UNIT SAFETY

### Rules of Operation

KNOW your Unit – before starting engine. Understand:

- How to operate all controls
- The functions of all controls
- How to STOP in an Emergency
- Speed ranges

### Walk Around Inspection

Complete a walk around inspection of unit and work area to understand:

- Work area
- Your unit
- All safety decals

### Safety Interlock System

Check Safety Interlock System for proper operation daily (see Operation section).

### Clearances

ALWAYS check overhead and side clearances carefully before operation.

ALWAYS be aware of traffic when operating along streets or curbs. Set up safety signs and/or flags.

## PERSONAL SAFETY

### Responsible Operators

- Only trained adults may operate unit.
- Training includes actual operation.
- Clearly understand instructions.
- Be alert! Conditions can change.

### Pre-Start

Before starting engine: disengage PTO and set parking brake.

### Hot Surfaces

DO NOT touch parts which are hot. Allow parts to cool.

### Safety Covers

ALWAYS keep discharge cover or complete grass bagger in place.

### Replacement Parts

ALWAYS maintain unit in safe operating condition. Damaged or worn out muffler can cause fire or explosion.

### Clear Area

ALWAYS clear area before operation. Thrown objects can cause injury.

### Speed Ranges

DO NOT mow at too fast a rate. DO NOT change engine governor settings or over speed the engine.

### Avoid loss of control

Avoid uneven work areas and any rough terrain.

## Thrown Objects

Disengage PTO when crossing hard surfaces and gravel drives. Be aware of mower discharge direction and do not point it at anyone.

Keep all safety covers:

- In place
- In proper working condition

## Safety Gear

Wear adequate safety gear, protective gloves and footwear. NEVER wear loose clothing, jewelry or long hair that may get caught in rotating parts.

Protect eyes, face and head from objects that may be thrown from unit.

## OPERATIONAL SAFETY

### Safe Distances

Keep children and people away from unit during operation. Use care when approaching blind corners, shrubs, trees or other objects that may obscure vision.

ALWAYS keep feet and hands away from all rotating blades. Rotating parts can cut off body parts.

### Starting

Start and operate unit only when seated in operator's position. Steering control levers must be in neutral, PTO disengaged and parking brake set when starting engine.

### Tip over

Avoid uneven, unstable and rough terrain. DO NOT operate near drop offs, ditches, or embankments. Unit can suddenly turn over if a wheel is over the edge of a cliff or ditch, or if an edge caves in.

### Reverse

ALWAYS backup slowly. ALWAYS look down and behind before and while backing. Do not operate in reverse unless absolutely necessary.

### Load Capacity

Use care when pulling loads. Use only approved drawbar hitch points. Limit loads to those you can safely control.

### Traction

If tires lose traction, turn off PTO and proceed slowly straight down slope. If you cannot back up the slope or feel uneasy, do not mow it. Avoid mowing wet grass.

### Parking Brake

Check brake operation frequently. Adjust and service as required.

### No Riders

Never carry passengers.

## Hazardous Slopes

Operate up and down slopes, not across slopes. DO NOT operate on slopes of more than 17°. Keep all movement on slopes slow and gradual. DO NOT make sudden changes in speed or direction. Use a slow speed to avoid stops or shifts on slopes. Avoid starting or stopping on a slope. Use of a Roll Over Protection System (ROPS) is recommended for slope operation. See Attachments and Accessories.

### Roll-Away

DO NOT leave unit unattended on a slope. ALWAYS set park brake when leaving unit.

### Operation

Only trained adults may operate unit. Training includes actual operation

### Visibility

ALWAYS operate unit when there is good visibility and light.

### NO Drugs

NEVER operate unit after or during the consumption of medication, drugs or alcohol. Safe operation requires your complete and unimpaired attention at all times.

### NO Alcohol

NEVER allow anyone to operate this unit when their alertness or coordination is impaired.

### Avoid Entanglement

Stay away from moving parts. Keep safety devices or guards in place and functioning properly. NEVER modify or remove safety devices.

### Enclosed areas

DO NOT run engine in an enclosed area. Always provide good ventilation.

### Explosive Fuel

Fuel is highly flammable and its vapors can explode. Use ONLY approved RED fuel containers.

NO Smoking!

NO Sparks!

NO Flames!

Allow engine to cool before servicing.

NEVER fill fuel tank when engine is running, hot or unit is indoors.

### Avoid Sharp Edges

Moving parts can cut or amputate fingers or a hand. Wrap blade(s) or wear gloves to service. Rotating one blade will cause other blades to rotate.

### Avoid Pinch Points

ALWAYS keep hands away from all pinch points.



## **Abnormal Vibrations**

Disengage PTO, stop engine, remove key and wait for all moving parts to stop before servicing or unclogging mower.

ALWAYS shut off engine, remove key and lower the mower to prevent unauthorized use before leaving unit.

## **Parking**

NEVER leave a running unit unattended. ALWAYS turn off PTO, lower throttle setting, set parking brake, and stop engine.

## **PTO Operation**

Turn off power to attachment when crossing drives, etc.

ALWAYS turn off PTO, shut off engine, remove key and wait for moving parts to stop before leaving operators position.

## **MAINTENANCE, SERVICE AND STORAGE SAFETY**

### **Storage**

DO NOT store unit with fuel in the fuel tank inside a building where any ignition sources are present. Allow unit to cool completely. Shut off fuel valve.

ALWAYS clean unit before extended storage. See engine manual for proper storage.

### **Battery**

Battery posts, terminals and related accessories contain lead and lead compounds, chemicals known to the State of California to cause cancer and reproductive harm.

Wash hands after handling.

Avoid Electric Shock. DO NOT reverse battery connections.

Explosive Gases! Poisonous battery fluid contains sulfuric acid and its contact with skin, eyes, or clothing can cause severe burns.

No flames, No sparks, No smoking near battery. ALWAYS wear safety glasses and protective gear near battery.

DO NOT TIP battery beyond a 45° angle in any direction.

ALWAYS KEEP BATTERIES OUT OF REACH of children.

### **Transport**

Use extra care when loading or unloading unit onto trailer or truck. Secure unit chassis to transport vehicle. NEVER secure from rods or linkages that could be damaged.

DO NOT transport with attachment in raised position.

Shut off fuel valve during transport.

### **Service Position**

ALWAYS block wheels and know all jack stands are strong and secure and will hold weight of unit during maintenance.

When opening engine cover, use care to properly engage cover prop into its retaining slot. Be sure footing is secure to accommodate weight shift of hood when rotating to full service position.

### **Hardware**

Keep nuts and bolts, especially blade attachment bolts, tight and keep equipment in safe operating condition.

Inspect blades before use for excess wear or damage.

Keep hardware, especially blade attachment bolts, tight.

### **Stop Engine**

Before maintenance, adjustments or service (except where specifically recommended) shut off engine and remove ignition key.

### **Cool Engine**

Allow hot parts to cool.

### **Cleaning**

Keep unit free of grass, leaves or other debris. Clean up oil or fuel spills.

Lower cutting deck when unit is parked or stored unless a positive mechanical lock is used.

### **Replacement Parts**

Keep all parts in good working condition. Replace worn or damaged parts only with Gravely recommended service parts.

### **Attachment and Accessory Safety**

Use only attachments or accessories designed for your unit.

### **Spark Arrester**

This product is equipped with an internal combustion engine. DO NOT use on or near any unimproved, forest covered or brush covered land unless the exhaust system is equipped with a spark arrester meeting applicable local, state or federal laws. A spark arrester, if used, must be maintained in effective working order by the operator.

# ASSEMBLY

## UNIT ASSEMBLY



**WARNING:** Make all seat adjustments with unit stationary, parking brake on and engine shut off.

### Package Contents:

Unit, Mower Deck and Literature Pack

### Preparation Checklist

Refer to the Owner/Operator manual as required.

1. Unpack Unit - Remove shrink wrap and packaging materials.
2. Remove Unit From Container - Open Bypass Valves (dump valves) (See *Moving the Unit with the Engine Off in Operation*).  
Push unit from container onto a level surface. Close the dump valves.
3. Tires - Adjust tire pressure for front tires; 20-25 PSI (138-172 kN/m<sup>2</sup>), rear tires; 12-15 PSI (83-103 kN/m<sup>2</sup>).
4. Position and Attach Seat - Remove nuts from seat studs in hood frame. Peel off paper backing from foam tape (260Z). Lift and rotate seat onto hood frame. Secure with nuts.
5. Position Steering Levers - Remove bolts and spacers from steering rod. Flip the steering levers up into operating position. Reinstall spacers, bolts and nuts. Tighten hardware securely. See Figure 4.
6. Battery - Remove battery from unit, fill with electrolyte and charge (See *Battery in Maintenance*).
7. Check Engine Crankcase - To access engine, open hood. Check and add oil if needed. See Engine Manual for specifications. After service is completed, close hood.

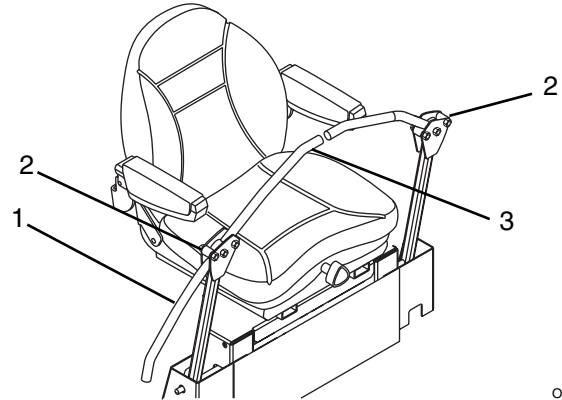

OF3140

1. Steering Lever in Shipping Position
2. Spacers and Hardware
3. Steering Lever in Operation Position

Figure 4

8. 60" & 72" Decks - Remove, reverse, and reinstall deflector and mounting bracket.



**WARNING:** Deflector must pivot freely. DO NOT over tighten the pivot bolts.

9. Fill Engine Fuel Tank - Add clean fuel to the fuel tank.

**IMPORTANT:** Refer to Engine Manual for fuel type.

10. Hardware - Check for loose hardware.
11. Check Safety Interlock System - Check to see that the interlock system operates correctly.



**WARNING:** FAILURE OF INTERLOCK together with improper operation can result in severe personal injury.

12. Lubrication - Lubricate all fittings per maintenance label under hood and check hydrostat oil level.
13. Level Deck - Check unit to assure deck level set at factory has been maintained.
14. Check Function of all Controls - Ensure unit runs and performs properly.



**WARNING:** FAILURE OF CONTROLS could result in death or serious injury.

# OPERATION

## CONTROLS AND FEATURES

See Figure 1 for Controls and Features locations.

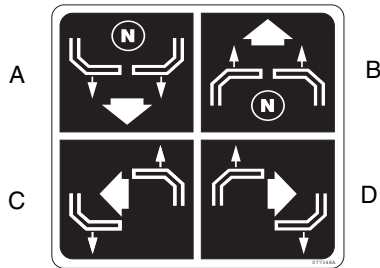

### Steering Levers

The control levers are used for both speed and direction control. In addition, they will stop the unit.

- A. For reverse travel, pull both steering control levers backward.
- B. For straight forward travel, push both steering control levers forward.
- C. To turn left, pull the left back or push the right Steering Control Lever forward or a combination of both.
- D. To turn right, pull the right back or push the left Steering Control Lever forward or a combination of both.

To stop, return both to the neutral position.

When released, levers should automatically return to neutral position.

**NOTE:** The steering controls are mechanically locked in neutral whenever the parking brake is engaged.

**NOTE:** Aggressive turning can scuff or damage lawns. ALWAYS keep both wheels rotating when making sharp turns. DO NOT make turns with inside wheel completely stopped. To obtain minimum turning radius, slowly reverse inside wheel while moving outside wheel slowly forward.

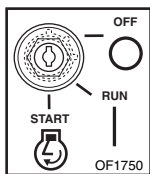

### Ignition Switch

The ignition switch is operated with a removable key. The switch has three positions: "Off", "Run" and "Start".

To start the engine, the key must be in the "Start" position. Once the engine has started release the key and it will return to the "Run" position. To stop the engine, turn the key to the "Off" position.

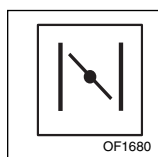

### Choke Control

The choke control is used to start a cold engine. Push the choke lever forward to choke the engine. Pull the choke lever to the rear when the engine gets warm.



### Throttle Lever

The throttle lever is used to change the speed of the engine. Moving the throttle lever to the "Fast" position increases the engine speed. Moving the lever to the "Slow" position decreases the engine speed.

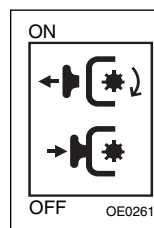

### Power Take Off (PTO) Switch

The power take off (PTO) switch is used to engage and disengage the mower. When the PTO switch is in the "On" position, mower is engaged; when the PTO switch is in the "Off" position, mower is disengaged. Pull for "On" and push for "Off".

**NOTE:** The engine will not start unless the steering control levers are in the neutral position and the PTO switch is in the "Off" position and parking brake is set.

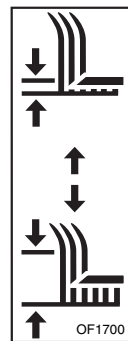

### Mower Lift Lever

The mower lift lever is used to raise and lower the mower deck. The lift lever is located on the left side of tractor. Move the lever rearward to raise, and forward to lower the deck. Release lever to hold in selected position. The approximate mowing height in inches is shown on the indicator located on the lift cylinder near operator's right foot.

### Cylinder Stops

The cylinder stops ensure the same cutting height after raising the deck to clear an obstacle. The stops are stored on a post under the operator's right leg. The stops are supplied in two (2) sizes. The thinner stops change the cutting height by 1/4" (.64 cm). The thicker stops change the cutting height by 1/2" (1.27 cm).

1. Remove the cylinder stops from the post and snap onto the lift cylinder rod.
2. Push the lift lever forward until the cylinder rests against the cylinder stops.



## Fuel Shut-Off Valve

This valve is used to control the flow of fuel leaving the fuel tanks. The valve must be open for the engine to operate. It should be turned to "OFF" if the unit is to be stored for extended periods. It is also used to select which fuel tank the engine will draw fuel from, right or left.

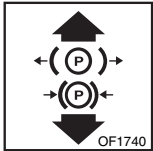

## Parking Brake Lever

1. Pull lever up to engage parking brake.
2. Push lever down to disengage parking brake.

## Seat Adjustments



**WARNING:** Make all seat adjustments with unit stationary, parking brake on and engine shut off.

To adjust seat forward or backward:

1. While seated, pull seat adjustment lever outward and slide seat into desired position.
2. Release lever and slide seat forward or back to lock seat into position.

To adjust seat suspension (260Z):

- To make seat more firm turn knob clockwise. To make seat less firm turn knob counter clockwise. Turn knob several turns at a time until desired position is achieved.

## Safety Interlock System



**WARNING:** Safety interlock system failure and improper operation of unit can result in death or serious injury. Test this system each time the unit is operated. If this system does not function as described, do not operate until repairs are made.

Engine must shut off if the operator attempts to leave the seat with the transmission engaged, parking brake disengaged or PTO engaged. Engine must not start unless PTO is disengaged and parking brake is engaged.

## Engine Oil Pressure Indicator

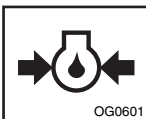

This will light up "Red" if the oil pressure is low. Check oil level and add if necessary. Refer to engine manual.

## Hour Meter

Hour Meter operates when Ignition Switch is in the "Run" position and records actual time engine operates.

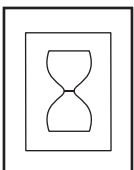

**IMPORTANT:** Keep a record of Hour Meter readings for recommended Lubrication and Maintenance intervals.

**NOTE:** For accurate readings be sure Ignition Switch is OFF when tractor is not in operation.

## PRE-START



**CAUTION:** Make sure all hardware is tight, all safety devices in place and all adjustments made correctly.

### 1. Check Safety Interlock System

If this system does not function as described do not operate until repairs are made.

### 2. Check Air Cleaner

Check air filter for dirt. Clean as required. See Maintenance Section.

### 3. Check Engine Fuel and Crankcase Oil

Check and add fuel if required. Check that engine crankcase oil is full. Refer to Maintenance Section.

### 4. Check Tire Pressure

### 5. Check Hydraulic Fluid Level

### 6. Adjust Seat

Be sure all controls can be reached safely from operator's position.

## STOPPING IN AN EMERGENCY

The unit can be stopped immediately at any time by turning the ignition key to the "Off" position.

## STARTING AND SHUT OFF



**CAUTION:** Read entire Owner/Operator Manual, Clutch Manual, and Engine Manual first.  
DO NOT attempt to start engine at this time.

To start the engine:

1. Make sure the control levers are in the neutral position.
2. Put the PTO switch in the "Off" position.
3. Set Parking Brake.
4. If the engine is cold, move the choke control to the "On" position. If the engine is warm or hot, do not use choke.
5. Move the throttle to 3/4 "Fast" position. See Engine Manual for detailed instructions.
6. Put the ignition key in the switch and turn it to the "Start" position.
7. As soon as the engine starts, release the key and move the choke control to the "Off" position from the "Choke" position. Wait until the engine is running smoothly before operation.

To stop the engine:

1. Bring the steering control levers to neutral.  
Disengage the PTO and set the parking brake.
2. Move the throttle lever to the "Slow" position.
3. Turn the ignition key to the "Off" position.

## TO MOW WITH UNIT

Operate the unit only when seated in the operator's position.

1. Start the engine. Let the engine warm until it is running smoothly.
2. Release parking brake.



**WARNING:** Move the steering control levers slowly and keep the throttle control lever at slow speed until you learn how to operate the unit.

3. Move the control levers to the neutral position.
4. Slow the engine down to about 3/4 speed.
5. Move the PTO switch to the "On" position to engage the mower.

**IMPORTANT:** Never engage the PTO if the mower is plugged with grass or other material. This may cause damage to the electric clutch.

6. Move throttle control to fast.
7. Move the control levers forward to obtain a slow ground speed.
8. To disengage the mower, move the PTO switch to the "Off" position.
9. When you know how to operate the unit, select a speed appropriate to your mowing conditions.

## PARKING

To park the unit:

1. Move the control levers to the neutral position. Turn off PTO.
2. Move the throttle lever to the "Slow" position.
3. Set the parking brake.
4. Lower the attachment.
5. Turn the ignition key to the "Off" position and remove the key.

## MOVING THE UNIT WITH THE ENGINE OFF

To move the unit without the engine running, rotate the bypass valve (dump valve) levers located on the pumps toward the center of the tractor approximately 1/2 turn using a wrench. Levers must be returned to their original position in order to operate the unit. (Figure 5)

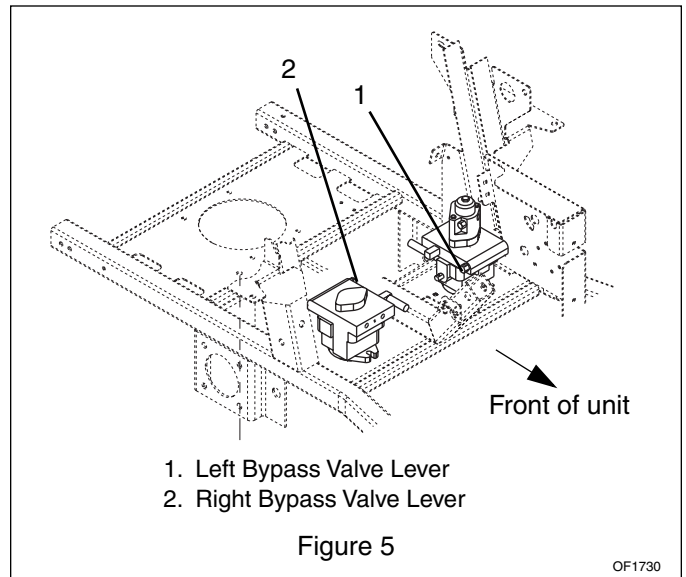

## FOR BEST PERFORMANCE

Cut grass when it is dry.

Keep mower blades sharp.

Keep mower deck properly leveled.

Adjust anti-scalp rollers to prevent scalping.

Do not set height of cut too low. For very tall grass, mow twice.

Do not travel too fast.

Mow with the engine set at full throttle.

When mulching, only remove 1/3 of grass length per cutting.

Discharge clippings into areas already cut.

Vary cutting pattern with each mowing.

Do not allow grass or debris to collect inside of mower deck. Clean after each use.

## MAINTENANCE

Gravely Dealers will provide any service which may be required to keep your unit operating at peak efficiency. Should engine service be required, it can be obtained from a Gravely Dealer or the engine manufacturer's authorized service center.



**WARNING: MOVING PARTS** can result in serious injury or death.

ALWAYS stop unit, remove key, and wait for moving parts to stop before attempting any maintenance procedures.

**ELECTRIC SHOCK** can result in serious injury or death and/or damage to equipment.

DO NOT remove wire from spark plug while engine is running.



**CAUTION: HOT SURFACES** may result in injury. DO NOT touch engine or drive parts which are hot from operation. Allow parts to cool before servicing.

### SERVICE POSITIONS

Service position for 260Z:

1. Place unit on a flat level surface. ALWAYS stop engine. Assure unit is secure and will not tip over. Strap and clamp onto lift if used.
2. Place steering levers in neutral position and set parking brake.
3. Unhook hood latches.
4. Firmly grasp engine frame and cover. Lift to desired service position. (Figure 6)



**CAUTION: WHEN OPENING ENGINE COVER,** USE CARE TO PROPERLY ENGAGE PROP INTO SLOT. Be sure footing is secure to accommodate weight shift of hood when rotating to full service position.

**Daily Service Position:** Place engine hood prop rod into service slot. Assure rod is engaged in slot properly.

**Full Service Position:** Slowly release frame after seat contacts foot board. Use care and be sure of your footing. Do not step on mower deck.

5. When service is complete, lower hood and secure with latches.

### Service Position for 250Z

Remove pin holding seat down on left rear corner. Firmly grasp seat frame handle and lift past vertical. Lay inverted seat on foot rest. When service is complete, return seat to upright position and reinstall pin.

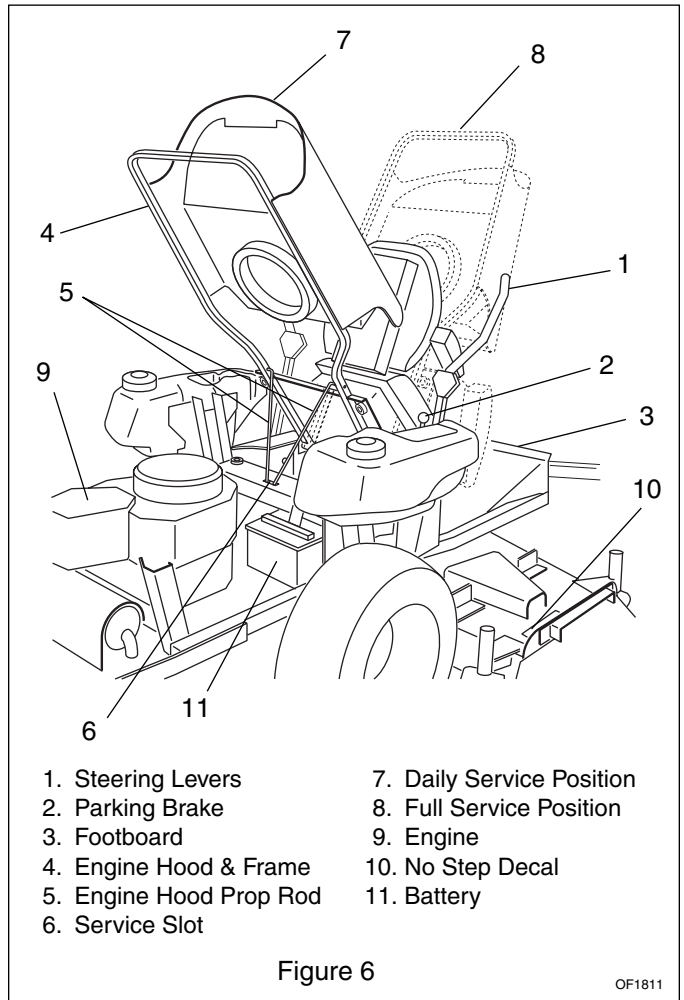

- |                         |                           |
|-------------------------|---------------------------|
| 1. Steering Levers      | 7. Daily Service Position |
| 2. Parking Brake        | 8. Full Service Position  |
| 3. Footboard            | 9. Engine                 |
| 4. Engine Hood & Frame  | 10. No Step Decal         |
| 5. Engine Hood Prop Rod | 11. Battery               |
| 6. Service Slot         |                           |

Figure 6

OF1811

### FILLING FUEL TANK



**WARNING: EXPLOSIVE VAPORS and FLAMMABLE FUEL** can result in serious injury or death. Handle fuel with care. ALWAYS use an approved (RED) fuel container.

No Smoking!

No Lighted Materials!

No Open Flame!

Allow engine to cool.

Use caution with fuel. Fuel is very flammable. Keep fuel in a clean and tight container. Keep fuel away from fire or heat. Never put fuel in the fuel tank while the engine is running or hot. Clean up any spilled fuel before starting the engine.

Add fuel to Fuel Tank as needed. See your Engine Manual for correct type and grade of fuel.

#### To add fuel to the fuel tank:

1. Refuel the unit only in a well ventilated open area.
2. Stop the engine.

3. Clean the fuel cap and the area around the fuel cap to prevent dirt from entering the fuel tank. Remove the cap from the fuel tank.
4. Fill the fuel tank. Be careful not to spill the fuel. Do not overfill, allow for fuel expansion. Stop filling when fuel is about 1" below the bottom of the neck.
5. Install the cap on the fuel tanks and tighten.
6. Clean up any spilled fuel before starting the engine.

## ENGINE

Correct maintenance can increase the life of the engine. See your engine manual for information on the operation and maintenance of your engine.

1. Before each use, check the level of the oil in the engine. Never operate the engine when the oil level is below the add mark.
2. Each day before operating, check the air cleaner element. Dirt can decrease the flow of air to the engine.
3. Each day before operating, check the air cooling system on the engine. Debris can decrease the flow of air cooling the engine.
4. Follow the maintenance instructions in your engine manual concerning oil changes and engine coolant changes.

## BELTS



**WARNING:** MOVING PARTS can cut or amputate body parts. ALWAYS wait for moving parts to stop before performing maintenance or service.



**CAUTION:** DAMAGED OR WORN BELTS may result in injury and/or damage to unit. Check belts for excessive wear or cracks often.

### Belt Access

1. Properly stop and park unit (refer to Operation Section).
2. Lower the mower.
3. Place seat in most reward position.
4. Remove belt covers.
5. Place foot board in open position (Figure 7).
6. Secure raised footboard with latch.

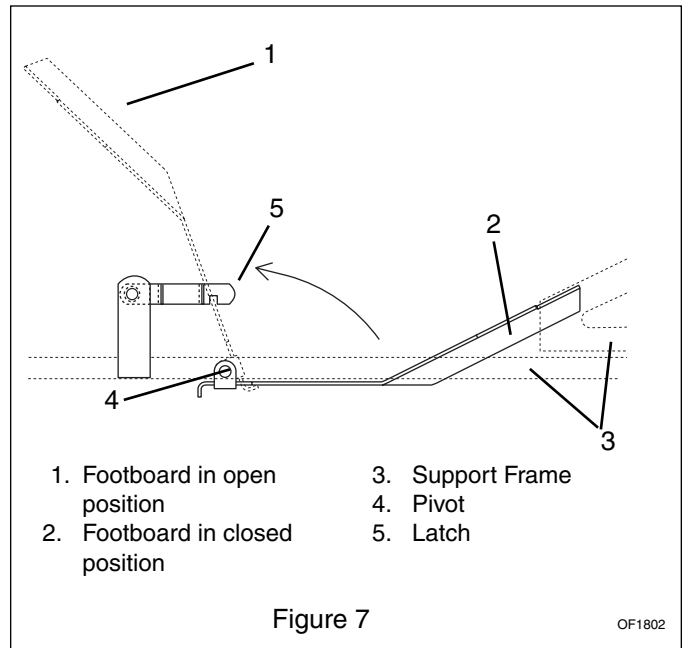

## Replacing Mower Belts

**NOTE:** Long belt must be removed to remove short belt.

1. Roll long belt off left blade spindle and remove from deck.
2. Roll short belt off right blade spindle and remove from deck. Idler pivot bolt must be loosened slightly to gain clearance to remove belt from under idler pulley (Figure 8).



**CAUTION:** Use care when releasing idler spring tension. Keep body parts well away from idlers when performing this operation.

3. Arrange new mower belt(s) on deck (short belt first). Retighten short belt idler pivot bolt. Install belts on sheaves. Roll belts onto blade sheave last.
4. Replace belt covers and return foot board to closed position.

## Replacing the Hydro Pump Belt

1. Properly stop and park unit (refer to Operation Section).
2. Remove the mower belt from the mower clutch sheave. See "Replacing Mower Belts".
3. Remove old hydro pump belt by rolling belt off right hand hydrostat sheave first (Figure 9).
4. Install new pump belt by positioning belt on sheaves. Roll belt onto right hand hydrostat sheave last.
5. Put the mower belt back on mower clutch sheave. See "Replacing Mower Belts".

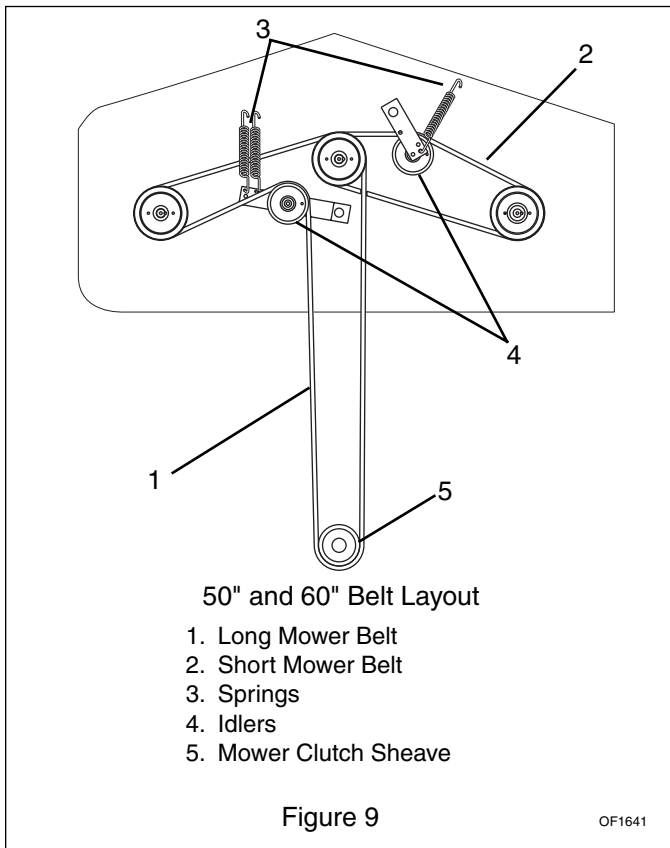
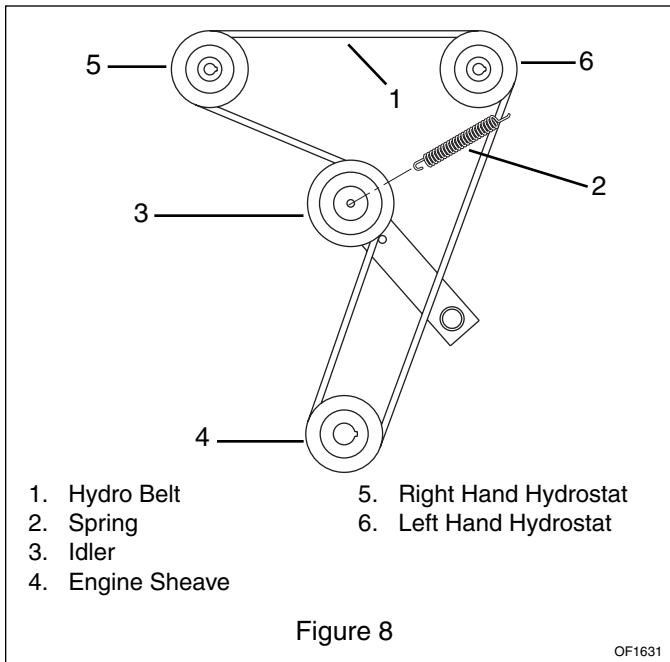

## TIRES

Before each use make a visual check of tires. The correct air pressure is 12-15 psi (83-103 kN/m<sup>2</sup>) for the rear tires and 20-25 psi (138-172 kN/m<sup>2</sup>) for the front tires.

## LUBRICATION

**IMPORTANT:** Wipe each fitting clean before and after lubrication.

Steering system and Speed Selector components should be lubricated every 50 hours of operation or every 3 months whichever comes first. (Figure 10)

Lube fitting locations are:

- each deck push arm (2)
- Hydro Idler (1)
- front axle pivot (1)

Apply Stens Mix Hi-Temp Grease or equivalent to the lube fittings. Order P/N: 00036700 - ten pack of 14 oz. cartridges.

When using Stens Mix Grease for the first time, all components should be thoroughly cleaned prior to lubricating.

Apply oil at all pivot points and pin connections.

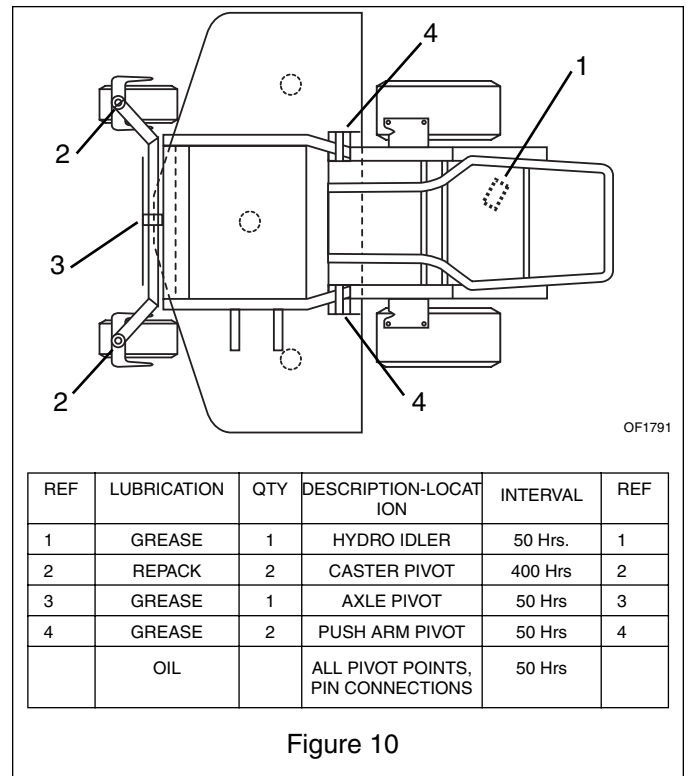

## FASTENERS

Before each use, check mower blade mounting hardware and all other fasteners. Replace fasteners that are missing or damaged. Tighten all nuts and bolts to their correct torque value.



## HYDRAULICS AND TRANSAXLES



**WARNING:** HYDRAULIC FLUID can result in severe burns. Fluid in hydraulic system can penetrate skin and result in serious injury or death.

Be sure to stop the engine before doing any work on hydraulic parts.

Keep body and hands away from pin holes or nozzles which expel hydraulic fluid when under pressure. Use paper or cardboard, not hands, to search for leaks.

Insure all hydraulic fluid connections are tight and all hydraulic hoses and lines are in good condition before applying pressure to system. FOREIGN FLUID INJECTED INTO BODY can result in gangrene. Fluid must be surgically removed within a few hours by a doctor familiar with this form of injury.

### Checking the Hydraulic Fluid Level

A check of the hydraulic fluid level should be made daily.

**NOTE:** The oil level can be checked with dipstick check.

To Check: first remove any dirt that may be around the cap on the tank.

The oil level should be between two marks on dipstick. Centered between the marks is best.

Add oil through the dipstick tube as needed. Do not overfill.

### Changing Hydraulic Fluid

The hydraulic oil filter and hydraulic oil should be changed after the first 500 hours. Use Mobil 15W50 synthetic oil for best component life.

1. Clean around dipstick cap and dipstick. Remove dipstick.
2. Place container under oil filter to catch oil.
3. Remove oil filter.
4. Allow tank to drain.
5. Install new oil filter.
6. Add new oil to the oil tank. It will take about 5 quarts. Use Mobil 15W50 synthetic oil for best pump and wheel motor life.
7. Properly dispose of waste oil.

## MOWER BLADES

**NOTE:** If mower is used under sandy soil conditions, replace blades when air lifts become eroded through at ends (Figure 11).

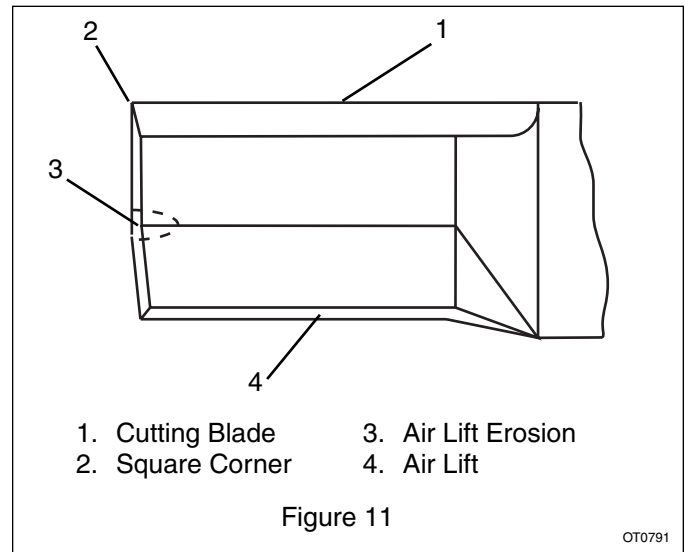

### Sharpen the Mower Blades



**CAUTION:** Use sturdy gloves or padding to protect hands when working with mower blades.

1. Turn the engine off. Remove the ignition key. Remove the ignition wire from the spark plugs.
2. Remove the bolts, lock washer, the flat washers, and the blades from the spindle shafts.
3. Sharpen the beveled edges of the blades in a straight line. Do not change the angle of the beveled edge. If more than 0.5 inches (12.7mm) are removed from the width of a blade, discard the blade. Make sure the sharpened blades are balanced. Balance must be held within 1.3 inch ounces.
4. Put the blades, the flat washers, lock washers, and the bolts back on the spindle shafts.
5. Tighten the bolts to a torque of 70 ft. lbs.
6. Put the ignition wires back on the spark plugs.

## BATTERY

When charging battery remove it from unit first. Keep batteries out of reach of children. ALWAYS follow information provided on battery by the battery manufacturer. Lead acid batteries generate explosive gases. Severe chemical burns can result from improper handling of battery electrolyte. Wear safety glasses and proper protective gear when handling batteries to prevent electrolyte from coming in contact with eyes, skin or clothing.



**WARNING:** ELECTRIC SHOCK may result in injury and/or damage to unit.

DO NOT allow tools or other objects to come into contact with both terminals at same time.

ALWAYS remove Negative (-) Cable first to reduce risk of sparks when removing Battery.

ALWAYS connect Positive (+) Cable first, then connect Negative (-) Cable when installing battery.



**WARNING:** EXPLOSIVE GASES can result in serious injury or death. ALWAYS keep open flames, sparks, or smoking materials away from Battery.

POISONOUS BATTERY FLUID contains sulfuric acid and its contact with skin, eyes or clothing can cause severe chemical burns. ALWAYS wear safety glasses and protective gear near battery.

DO NOT TIP any battery beyond 45° angle in any direction.

ALWAYS KEEP BATTERIES OUT OF REACH of children.



**WARNING:** REVERSE CONNECTIONS may result in sparks which may result in injury. ALWAYS connect/disconnect cables in proper order.



**WARNING:** Battery posts, terminals and related accessories contain lead and lead compounds, chemicals known to the State of California to cause cancer and reproductive harm. Wash hands after handling.

### Battery Electrolyte First Aid

- **External Contact:** Flush with water.
- **Eyes:** Flush with water for at least 15 minutes and get medical attention immediately!
- **Internal Contact:** Drink large quantities of water. Follow with Milk of Magnesia, beaten egg or vegetable oil. Get medical attention immediately!

**IMPORTANT:** In case of internal contact, DO NOT induce vomiting!

### Terminals

Keep battery and its terminals clean. Inspect monthly to maintain best performance. To clean terminals, remove battery from unit by removing cables.

Remove tie down rod nuts and lift battery out. Clean or service battery away from unit. Remove corrosion from battery terminals and cable connections with wire brush, then wash with a weak baking soda solution.

After cleaning, apply a thin coat of grease or petroleum jelly to terminals and cable ends to retard corrosion. Reinstall battery.

### Electrolyte Level

Every 25 hours of operation check electrolyte level of each cell by removing caps one at a time. The electrolyte level should be at level indicated. Use distilled water to fill each cell if needed. Install and tighten each cap after checking.

**IMPORTANT:** When distilled water is added to battery during freezing weather, battery must be charged to mix water with electrolyte, or water will remain at top and freeze.

### Battery Charger

Under normal conditions the engine alternator will have no problem keeping battery charged. When unit has set for an extended period of time without operation and the battery has been completely discharged, a battery charger will be required for recharging.

Before using a charger, an attempt can be made to recharge the battery using the engine alternator by jump starting the unit and allowing the engine to run.

### Charging



**WARNING:** FROZEN BATTERIES CAN EXPLODE and result in death or serious injury. DO NOT charge a frozen battery. Let the battery thaw out before putting on a charger.

**IMPORTANT:** DO NOT fast charge. Charging at a higher rate will damage or destroy battery.

ALWAYS follow information provided on battery by battery manufacturer. Contact battery manufacturer for extensive instructions to charge battery.

1. Put unit into service position to gain access to battery.
2. Disconnect negative (-) cable first, then positive (+) cable (Figure 12).
3. Remove hold down and remove battery.
4. Place Battery on bench or other well ventilated place where electrolyte spill will not create damage.
5. **Initial Battery Setup** - Remove caps and fill each cell to level indicated with electrolyte at 1.230± specific gravity and 80°F (27°C).
  - Let battery stand for one half hour.
  - Check electrolyte level and add more if necessary.
6. Connect positive (+) lead of charger to positive (+) terminal, and negative (-) lead to negative (-) terminal.
7. Charge the battery at two and a half amps for ten hours or until all cells are gassing freely and the specific gravity is constant over three 30 minute intervals.

8. Immediately after charging, check electrolyte level. If low, add distilled water to bring cell up to required level.
9. Replace caps finger tight, wash off and dry battery.
10. Reinstall battery into unit and connect positive (+) cable first, then negative (-) cable.

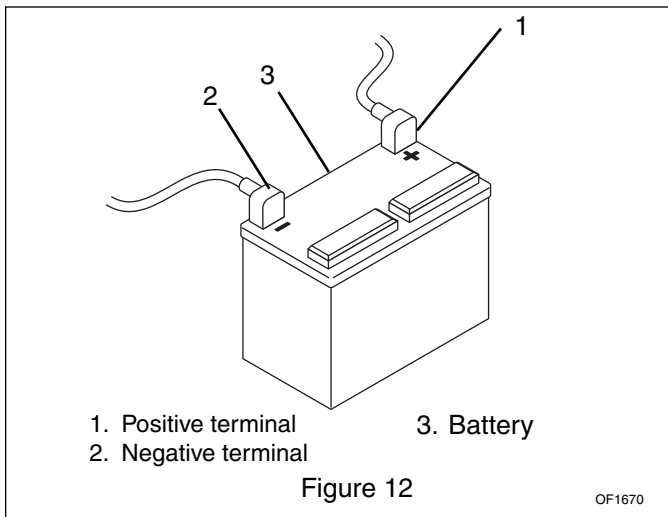

### Jump Starting

The unit used for jump starting should have a 12 volt battery with at least 500 cold cranking amperes, and a negatively grounded system.

1. Ensure battery is not frozen. If the fluid is frozen, remove battery from unit and allow it to thaw before charging.
2. Connect the positive (+) jumper cable to the positive terminal of the discharged battery.
3. Connect the other end of the same jumper cable to the positive (+) terminal of the booster battery.
4. Connect one end of the second jumper cable to the negative (-) terminal of the booster battery.
5. Make the final jumper cable connection to the engine block or the furthest ground point away from the discharged battery.



**WARNING:** Make sure cables are clear of any moving engine parts before starting engine.

6. Start engine (refer to Operation Section). If engine will not start after several tries, unit or battery may need service.
7. After engine starts, leave cables connected for one to two minutes.
8. Disconnect cables in reverse order.
9. Operate unit as normal to charge battery.

## ADJUSTMENTS

### Steering Control Neutral Adjustment

If the unit has excessive creep when the control levers are in neutral, adjust as follows. (Figure 13)

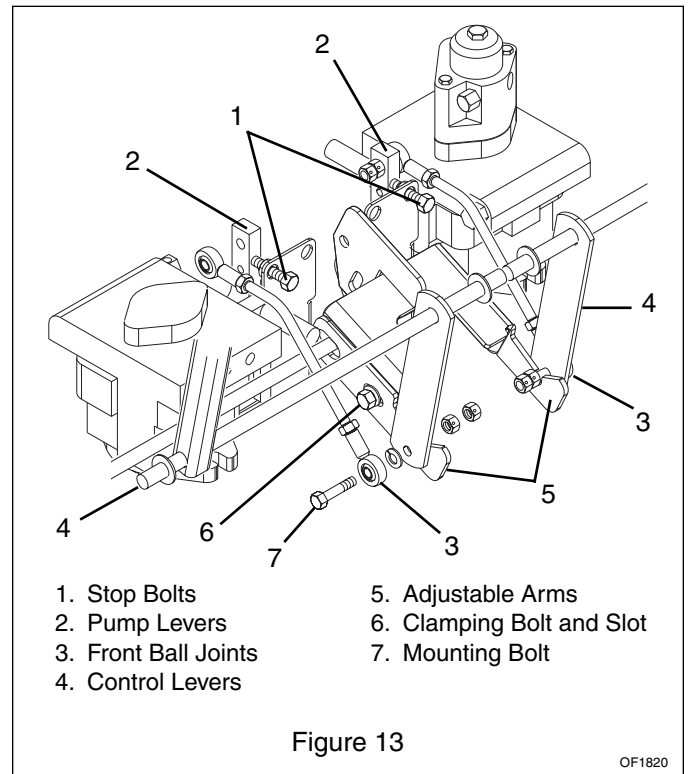

**WARNING:** This adjustment requires operation of the engine and opening of hood. Use extreme care to avoid contact with moving parts and hot surfaces. Be sure rear of unit is well supported and secure before starting engine.

1. If hydraulic system is cold, run unit for a minimum of five minutes, then shut off unit.
2. Make sure both control levers are in neutral. Raise hood.
3. With the unit up to and facing a wall, jack the unit up so that both drive wheels are off the ground.
4. Have someone depress center of seat to actuate seat switch.
5. Start the engine and run at about half throttle or faster. Release parking brake.
6. Move the control levers from Forward to Reverse several times to make sure controls are free and check Neutral adjustment. If binding is found, correct it.
7. Minor adjustments may be made by simply adjusting the stop screw which contacts the lever on the pump. The screw may be turned in or out to bring the unit into neutral.

8. If major adjustment is needed, it is best to remove the front ball joint from the bottom of the control levers and turn the stop screw in or out until neutral is found.
9. Then, with the adjustable arms of the parking brake set so the clamping bolt is in the middle of the slot, adjust the ball joint on or off the control link rod so that their mounting bolts fit into the slot at the end of the adjustable interlock.
10. Reinstall the front ball joint(s).

**NOTE:** When properly adjusted, the parking brake interlock will move upward when the parking brake is set and hold the steering control levers in neutral. The parking brake starting interlock switch will not be depressed unless the steering control levers are in neutral. The interlock holds the levers in neutral until the parking brake is released.

11. Move the control levers, from forward to reverse several times to make sure it is adjusted to neutral. Readjust if necessary.
12. Stop the engine.

### Adjusting Control Levers

To be done after neutral has been set. (Figure 13)

1. If desired the steering control levers can be set to match (be in line) when in neutral.
2. Remove front ball joint from bottom of steering control lever on side which is going to be adjusted. Screw ball joint on or off link rod to hydrostat so that control levers align. Replace rod end on lower part of steering control lever.
3. If needed adjust parking brake interlock so that interlock is able to move up when both steering control levers are in neutral. To do this loosen the clamping bolt on the adjustable member of the interlock and slide it in either direction until the interlock moves up and latches the ball joint mounting bolts.

### Adjusting the Parking Brake

1. The Parking Brake may be adjusted through the use of the jam nuts on the brake rod which push against the compression spring which pushes on the caliper arm.
2. Turn the nuts further on the rod (clockwise) to tighten the brake and further off the rod (counter clockwise) to loosen the brake.
3. Ensure when the brake is applied, the caliper arm does not contact the return nuts on the rod in front of the caliper arm. If they do, back them off slightly.
4. When installing new pads in the calipers, they must be burnished by driving for a short distance (about 200 feet) with the brake on. To do this, bring the parking brake lever part-way up while driving normally (in a straight line). This quickly breaks-in the pads for maximum effectiveness.

### Adjusting the unit to Track Straight

Check and adjust tire pressure. Increase pressure on side unit tracks to. DO NOT exceed maximum recommended tire pressure (refer to Specifications).

If tire pressure adjustment does not solve tracking problem, the limiter bolts at base of handles can be adjusted. Front bolts are for forward and rear bolts are for reverse. Lengthen bolts (move closer to lever) on side which is too fast.

### Adjusting Anti-Scalp Rollers

The anti-scalp rollers are set at the factory for typical mowing height, but can be adjusted for high or low cutting conditions.

Rollers are intended to prevent lawn scalping, not to control cutting height.

For a very high cutting height, set the rollers in their lowest position on the bracket.

For a very low cutting height, set the rollers in their highest position on the bracket.

All rollers should be set at the same height.

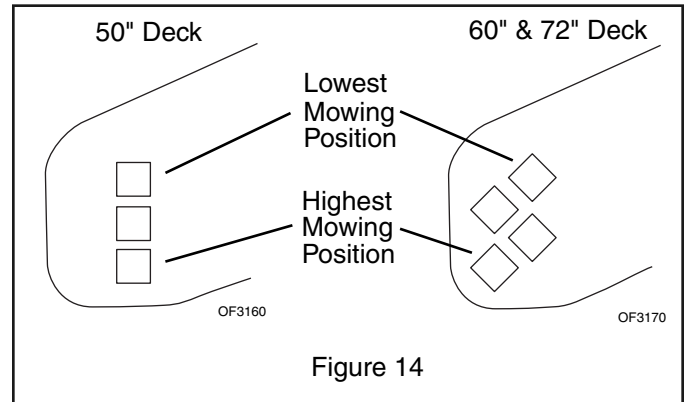

### Leveling the Mower Deck

These adjustments should be made on a level surface with the tires inflated to the correct air pressure.

The mower is leveled from side to side with the slots where 4 chains fasten to the mower mounting brackets. The mower is leveled from front to rear by adjusting the rod running down each side of the frame (Figure 15).

1. Raise mower deck and insert 3" (7.6 cm) tall blocks to support deck.
2. Lower deck onto blocks so chains are slack.
3. Measure from bottom of mower blade end to ground.
4. Set hydraulic lift cylinder so cut of height reads the same as blade height measurement.
5. Loosen the locknuts on the side where the chains are slack and slide the bolt down the slot until the chain is tight.
6. Tighten bolt and nuts in mower mounting brackets.
7. Lift mower and remove blocks.
8. Measure height of deck at each side. Measurements must be within 1/16" (1.5 mm) of each other.

9. If measurements are out of range, fix by adjusting chains on low side of deck.
10. Once deck is level side to side, measure height of deck at middle of front and on both sides of rear. Front of deck should be 1/8" (3 mm) lower than rear.
11. To adjust, loosen rear hex nut of the front mower lift pivot on each rod.
12. Turn the front hex nut on each rod until mower is 1/8" (3 mm) lower in front.

**NOTE:** If mower cannot be leveled it may be necessary to loosen the rear nut of the rear mower lift pivot to get more threads at the front of rod for adjustment. After loosening rear nut and adjusting level, tighten front nut on rear mower lift pivot.

13. Tighten rear hex nut on each rod that was loosened in step 11.

**NOTE:** Do not use harsh or abrasive cleaners on any painted surface. Do not allow gasoline or oil to remain on any surface.

### Engine

Refer to the engine manual to prepare the engine for storage.

### Battery

Remove battery and store in cool, dry place.

### To Take the unit Out of Storage

1. Refer to the engine service manual to prepare the engine for service.
2. Put fresh, clean fuel in the fuel tank.
3. Begin the maintenance schedule.
4. Charge and install the battery.

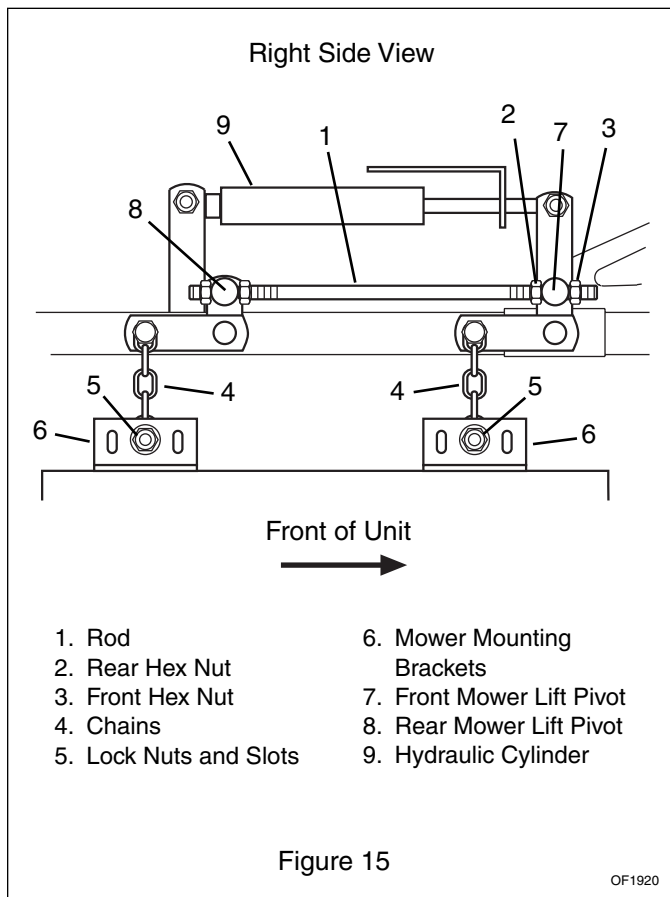

## CLEANING AND STORAGE

### Storage - Two Months Or More

Do the each use and 25-hour maintenance, but do not add gasoline.











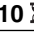
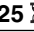
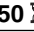
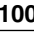
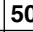

Clean the tractor. Paint or oil bare metal surfaces to prevent rust.

**IMPORTANT:** Never spray unit with water or store unit outdoors. Water can seep into sealed bearings, which are sealed against dirt and debris only, causing reduced component life.

## MAINTENANCE SCHEDULE

Proper maintenance can prolong the life of unit. The following charts show the recommended service schedule. More frequent service may be required due to working conditions (heavy loads, high ambient temperatures, dusty conditions, or airborne debris).

See the maintenance instructions in the Engine Manual for additional information.

MAINTENANCE SCHEDULE						
Service Performed	Daily	10 	25 	50 	100 	500 
 <input checked="" type="checkbox"/> Engine Oil	●					
 <input checked="" type="checkbox"/> Safety Interlock System	●					
 <input checked="" type="checkbox"/> Air Cleaner	●					
 <input checked="" type="checkbox"/> Hydraulic Fluid	●					
 <input checked="" type="checkbox"/> Blades	●					
 <input checked="" type="checkbox"/> Tires	●					
 <input checked="" type="checkbox"/> Battery and Battery Fluid			●			
 Engine Oil				*	●	
 <input checked="" type="checkbox"/> Fasteners					●	
 <input checked="" type="checkbox"/> All Belts					●	
 Fuel Filter					●	
 Hydraulic filter & oil						●

\* 50 hours or every season for 250Z.

## SPECIFICATIONS

Model Number	992020 & 022	992018	992021	992023	992024	992027
Model	PM260Z 25 HP Kohler with 60" deck	PM260Z 25 HP Kohler with 50" deck	PM260Z 22 HP Robin with 50" deck	PM250Z 20 HP Briggs & Stratton with 50" deck	PM260Z 22 HP Robin with 60" deck	PM260Z 25 HP Kohler with 72" deck
Length – cm (in)	221 (87) *					229 (90)
Height – cm (in)	127 (50)					
Width – cm (in)	185 (73)	160 (63)			185 (73)	216 (85)
Weight Actual – kg (lbs)	510 (1125)	499 (1100)	500 (1103)	490 (1080)	511 (1128)	572 (1259)
Battery	12 volt					
Brakes	Hydro/Dynamic Disk– Parking					
Turning Radius	0					
Tire Size Front Rear	15 x 6 - 6 23 x 10.5 - 12			15 x 6 - 6 23 x 8.5 - 12	15 x 6 - 6 23 x 10.5 - 12	
Engine – manufacturer	Kohler	Kohler	Robin	Briggs & Stratton	Robin	Kohler
Model Number	CV25S		EH65V	351777	EH65V	CV25S
Cycle	4					
Engine Power – H.P. (KW/min <sup>-1</sup> )	25 H.P. (18.4 KW/min <sup>-1</sup> )		22 H.P. (16.2 KW/min <sup>-1</sup> )	20 H.P. (14.7 KW/min <sup>-1</sup> )	22 H.P. (16.2 KW/min <sup>-1</sup> )	25 H.P. (18.4 KW/min <sup>-1</sup> )
Starting System	Electric					
Fuel Tank Capacity	9 gals. US (34 liters)					
Fuel	See Engine Manual					
Idle RPM	1800					
Governed RPM	3600					
Air Cleaner	Large Capacity Dual Element					
Cooling Capacity	Air cooled					
Engine oil type	See Engine Manual					
Spark Plug Gap	See Engine Manual					
Transmission	Hydrostatic Drive					
Speed – Forward Max. Reverse Max.	9 MPH 4.5 MPH					
Transmission Lube	Mobil 1 15W-50 Synthetic					
Drive Clutch	Hydrostatic					
Tire Pressure Front Rear	20-25 psi 12-15 psi					
Lift System	Hydraulic					
Power Take Off	Electric PTO Clutch/Brake					
Mower Deck	High Performance					
Cutting Width – cm (in)	152 (60)	127 (50)			152 (60)	183 (72)
Cutting Height – cm (in)	2.5 - 12.7 (1 - 5)					
Cut Increments – cm (in)	Infinite between 2.5 - 12.7 (1 - 5)					

\* Serial numbers 000101 - 009999 are 229 (90).

## ATTACHMENTS & ACCESSORIES

See your Dealer to add these attachments to your unit.

892001 - ROPS

892002 - Grass Bagger-60"

892003 - Grass Bagger-50"

Enhance your unit with these accessories.

79200300 - 60" Side Discharge Deck-Mulch Kit

79200400 - 60" Side Discharge Deck-Discharge Cover

79200500 - 50" Side Discharge Deck-Mulch Kit

79200600 - 50" Side Discharge Deck-Discharge Cover

## Publication and Service Part List

Order the following parts through your Gravely Dealer:

Part No.	Qty.	Description
09251700	1	Parts Manual
03621100	1	Battery
21416800	1	Air Filter - Kohler
21527200	1	Air Filter - Robin
21530000	1	Air Filter, Dual Element - Briggs & Stratton
21410800	1	Fuel Filter - Kohler
08811700	1	Fuel Filter - Robin
21530400	1	Fuel Filter - Briggs & Stratton
21397200	1	Engine Oil Filter - Kohler
21526900	1	Engine Oil Filter - Robin
21530700	1	Engine Oil Filter - Briggs & Stratton
09246900	1	Hydraulic Filter
21525900	2	Spark Plug - Kohler
21526900	2	Spark Plug - Robin
21531100	2	Spark Plug - Briggs & Stratton
07237800	1	PTO (Engine to Deck) Belt (72")
07235100	1	PTO (Engine to Deck) Belt (60")
07234600	1	PTO (Engine to Deck) Belt (50")
07237700	1	Mower Drive Belt (72")
07235000	1	Mower Drive Belt (60")
07234900	1	Mower Drive Belt (50")
07235500	1	Traction (Transmission) Belt
21416700	1	Element Precleaner - Kohler
21527200	1	Element Precleaner - Robin
09246700	1	Blade 50"
08899200	1	Blade Mulching 50"
09246600	1	Blade 60"
08899100	1	Blade Mulching 60"
09097100	1	Blade 72"

Mail Requests to: Gravely  
655 West Ryan St.  
P.O. Box 157  
Brillion, WI 54110-0157





**Gravely Division of Ariens Company**  
655 West Ryan Street  
P.O. Box 157  
Brillion, WI 54110-0157  
920-756-2141  
Fax 920-756-2407

## 2 Year Limited Warranty

Ariens Company hereby warrants to the original consumer purchaser that all Gravely Two-Wheel, Professional G, Pro, and ProMaster products will be free from defects in material and workmanship for a period of two (2) years from the date of purchase or 1000 hours, whichever comes first.

### Protection Plan

Ariens Company will repair or replace any part found upon examination by the Ariens Company to be defective. Such repair or replacement will be free of charge to the purchaser (labor and parts), except as noted below.

**This warranty is subject to the following exceptions, conditions, and limitations:**

### Usage Requirement

The duration of this warranty shall be ninety days or 1000 hours, whichever comes first, if the product is rented or leased.

### Purchaser's Responsibilities

- The purchaser must perform maintenance & minor adjustments per the operator's manual.
- The purchaser must notify Ariens Company or an authorized Gravely service representative of the need for warranty service.
- The purchaser must transport the product to and from the place of warranty repair.

### Product Registration

- The Gravely dealer must fill out and return the warranty registration card to validate the warranty.

### Service Parts and Accessories

- Service parts and accessories not purchased with the product covered by this warranty are warranted to be free of defects for a period of ninety (90) days following the date of purchase, and will be replaced free of charge (except for labor).

### Service

- Warranty service must be done by an authorized Gravely dealer. To find a Gravely dealer near you, contact Ariens Company.

### Battery Warranty Prorated

- One to three months - Free replacement
- Four to twelve months - Prorated over 12 months

### Exclusions (No Warranty)

- Normal maintenance, services, and normal replacement items, such as spark plugs, oil, oil filters, air filters, mufflers, belts, tires, shoes, runners, scraper blades, shear bolts, mower blades, mower vanes, headlights, light bulbs, knives, etc. are not covered by this warranty.
- Any equipment which has been altered, misused, misassembled, improperly adjusted, neglected, or damaged by accident is not covered by this warranty.
- Service completed by someone other than an authorized Gravely dealer is not covered by this warranty.
- Any attachment not approved by Gravely nor any parts that are not genuine Gravely service parts are not covered by this warranty.
- Engines and engine accessories are covered only by the warranty made by the engine manufacturer, and are not covered by this warranty.
- This warranty applies only to products purchased in the United States (including Puerto Rico) and Canada. In all other countries, contact place of purchase.

Ariens Company may from time to time change the design of its products. Nothing contained in this warranty shall be construed as obligating Ariens Company to incorporate such design changes into previously manufactured products, nor shall such changes be construed as an admission that previous designs were defective.

### LIMITATION OF REMEDY AND DAMAGES

Ariens Company's liability under this express warranty, and under any implied warranty that may exist, is limited to repair or replacement of any defective part. In no event shall Ariens Company be liable for incidental, special, or consequential damages (including lost profits). This warranty gives you specific legal rights. You may also have other rights which vary from state to state. Some states do not allow the exclusion of incidental or consequential damages, or limitations on how long an implied warranty lasts, so the above limitations and exclusions may not apply to you.

### DISCLAIMER OF FURTHER WARRANTY

**Ariens Company makes no warranty other than what is expressly made in this warranty. If the law of your state provides that an implied warranty of merchantability, or an implied warranty of fitness for a particular purpose, applies to Ariens Company, any such implied warranty is limited to the duration of this express warranty.**

Form: GLW2-062399



**GRAVELY**

A Division of Ariens Company

655 West Ryan Street

P.O. Box 157

Brillion, WI 54110-0157

920-756-2141

Fax 920-756-2407

[www.gravelly.com](http://www.gravelly.com)